

REPAIR OPTIONS

(320D2/ 325D/ 329D/ 330C/
330D/ 336D/ 336D2)



Engine
Repair Options



Hydraulic
Repair Options



Drive Train
Repair Options

Engine Repairs Options

Repair Options 1

Top End Overhaul

- Remove and install cylinder head
- Recondition cylinder head Assembly
- Recondition Turbocharger
- Check condition of the cylinder block top deck
- Measure cylinder liner protrusion
- Clean and test water cool after cooler core or replace (If integral)
- Recondition rocker shaft and arm assemblies
- Repair or replace manifold(s) as required (inline engines only)
- Inspect fuel lines and replace if necessary
- New Valve (Inlet/Exhaust)
- New Valve Guide & Valve Seat
- New gaskets and seals
- Inspect top radiator hose(s) and replace if necessary
- Firm written quote for all recommended repairs Beyond RO part lists
- Check and adjust high/low idle, all fuel settings and timing as required and performance test



Repair Options 2

Engine Overhaul

- Clean Engine Disassembled
- Paint Engine
- Wash and Clean Engine
- Disassemble and Assemble Engine
- New bearings
- New gaskets and seals
- Recondition Turbocharger
- Recondition Engine Oil Cooler
- Recondition Alternator
- Recondition Fuel Transfer Pump
- Recondition Fuel Injection system
- Recondition Engine Oil Pump
- Clean crankcase breather
- Recondition starter and alternator
- Recondition Water Pump
- Recondition Fan Drive
- Recondition Piston and Liner set (All)
- Recondition Crankshaft
- Recondition Cylinder Head Assembly
- PM Parts(include engine oil)
- Firm written quote for all recommended repairs Beyond RO part lists

HYDRAULIC REPAIR OPTIONS

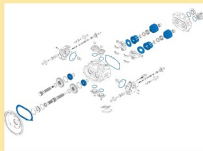
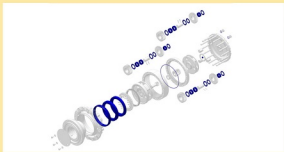

RESEAL BASIC

- >> Easy and complete seal kit
- >> Controlled cost
- >> Highly skilled and qualified technician
- >> Guaranteed parts and service warranty
- >> Timely quotes and repair turnaround
- >> 12 months parts warranty

PARTS AND SERVICES INCLUDED

- Disassemble & Assemble
- Cleaning of all parts
- Inspection and evaluating of all parts by a qualified technician to determine replacement according to Caterpillar Reuse and Salvage Guideline
- Replace all worn parts
- Replace seals and bearings

INSPECTION POINTS

- Plates
- Barrel assembly
- Piston and Slipper
- Housing and cover
- Drive/Driven shaft
- Actuator and valves
- Other related hydraulic components

CYLINDER REPAIR OPTIONS



RESEAL BASIC

- >> Extends cylinder Life
- >> Lowers cost of ownership through maximized fuel efficiency and improved cycle times
- >> Reduces risk for unplanned downtime
- >> Repairs internal leaks (cylinder drift)
- >> Reduces risk of contaminate entry into the hydraulic system
- >> 12 months parts warranty

PARTS AND SERVICES INCLUDED

- Disassembly of cylinder
- Cleaning of cylinder components
- Replacement of all cylinder piston and head seals
- Properly torque piston rod nut or bolt(s)
- Reassemble cylinder

INSPECTION POINTS

- Bearings (Eye and/or trunnion bushings)
- Rod and rod eye
- Interior walls of cylinder
- Threads
- Piston
- Piston nut or bolt(s)
- Head

ဖုန်း- ရန်ကုန်-(၉၅-၉)၉၇၇၀၀၇၇၇၊ မန္တလေး-(၉၅-၂)၅၁၅၃၄၅၊ ၅၁၅၃၄၆ Hotline: (၉၅-၉)၇၇၇၀၄၇၀၉၄



M S P

