

320D C6.4 Engine Repair Options

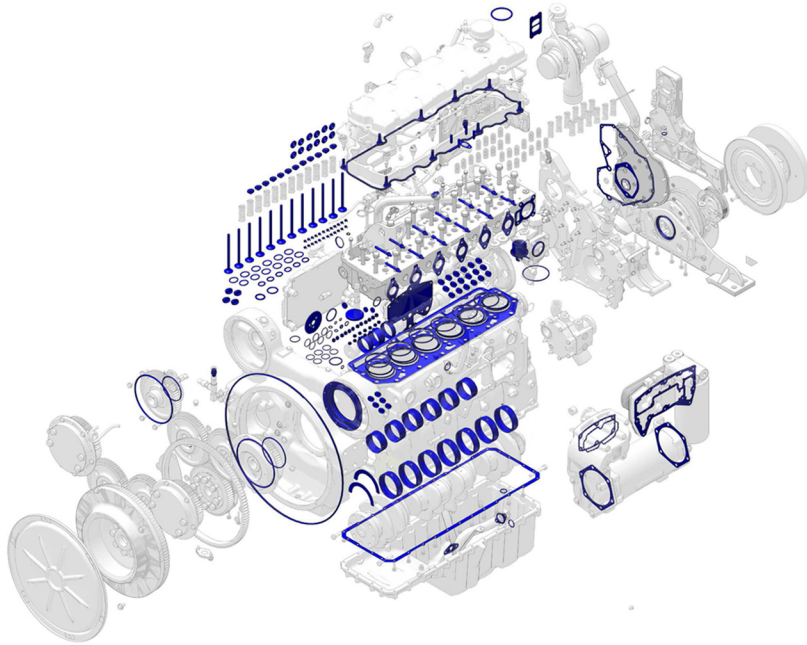

Rebearing/Reseal

- >> Extends life of the engine before failure
- >> Reduces oil consumption/smoke
- >> Improves starting ability
- >> Restores power
- >> Restores fuel consumption level
- >> 12 months parts warranty

EXTENDS LIFE

(Rebearing & Resealing) - Repair Options-2

- All Gasket and Seals(Top End/Central/Lower)
- Piston Rings
- Inlet Valves & Exhaust Valves
- Valve Cotters & Valve Seals
- Valve Seats & Valve Guides
- Bolts/Nuts & Washers
- Regulator
- PM Service-Oil, Fuel,Water/Engine Oil Filter
- Main Bearings & Rod Bearings
- Bushings, Pin Cotters & Thrust Plates
- Bearings(Fan Pulley)
- V-Belt

Warranty _____

Customer Name _____

Contact Phone No. _____

Date _____

Model _____

Serial No. _____

Total Estimated Price _____

Sales Person _____

Contact Phone No. _____

Turn Around Time _____

M S P



320D C6.4 Engine Repair Options

Repair Option (RO-1)	Repair Option (RO-2)	Repair Option (RO-3)	Repair Option (RO-4)
<ul style="list-style-type: none"> • All Gasket and Seals(Top End) • Inlet Valves & Exhaust Valves • Valve Cotters & Valve Seals • Valve Seats & Valve Guides • Bolts/Nuts & Washers • Regulator • PM Service-Oil, Fuel,Water/Engine Oil Filter 	<ul style="list-style-type: none"> • All Gasket and Seals(Top End/Central/Lower) • Piston Rings • Inlet Valves & Exhaust Valves • Valve Cotters & Valve Seals • Valve Seats & Valve Guides • Bolts/Nuts & Washers • Regulator • PM Service-Oil, Fuel,Water/Engine Oil Filter • Main Bearings & Rod Bearings • Bushings, Pin Cotters & Thrust Plates • Bearings(Fan Pulley) • V-Belt 	<ul style="list-style-type: none"> • All Gasket and Seals(Top End/Central/Lower) • Piston Rings • Inlet Valves & Exhaust Valves • Valve Cotters & Valve Seals • Valve Seats & Valve Guides • Bolts/Nuts & Washers • Regulator • PM Service-Oil, Fuel,Water/Engine Oil Filter • Main Bearings & Rod Bearings • Bushings, Pin Cotters & Thrust Plates • Bearings(Fan Pulley) • V-Belt • Liners/Pistons & Pins • Plate(Front Gear) • Hose & Clamps • Injection Pipes • Bearings/Impeller(Water Pump) • Bearing/Brush/Packing (Starting Motor GP-Electric) • Bearing/Nuts & Bolts Set (Alternator GP-Charging) • Mount-Isolation 	<ul style="list-style-type: none"> • All Gasket and Seals(Top End/Central/Lower) • Piston Rings • Inlet Valves & Exhaust Valves • Valve Cotters & Valve Seals • Valve Seats & Valve Guides • Bolts/Nuts & Washers • Regulator • PM Service-Oil, Fuel,Water/Engine Oil Filter • Main Bearings & Rod Bearings • Bushings, Pin Cotters & Thrust Plates • Bearings(Fan Pulley) • V-Belt • Liners/Pistons & Pins • Plate(Front Gear) • Hose & Clamps • Injection Pipes • Bearings/Impeller(Water Pump) • Bearing/Brush/Packing (Starting Motor GP-Electric) • Bearing/Nuts & Bolts Set (Alternator GP-Charging) • Mount-Isolation • Hose Assemblies & Tubes • Cap As Pressure/Spindle(Front Housing) • Shaft(Water Pump) • Fuel Valve Assembly • All Engine Electrical Sensors & Injector Harness
Total Parts & Service Charges	Total Parts & Service Charges	Total Parts & Service Charges	Total Parts & Service Charges

ADDITIONAL PARTS	NEW	REMAN
• Crankshaft	•	•
• Camshaft	•	•
• Water Pump	•	•
• Oil Cooler	•	•
• Connection Rod	•	
• Cylinder Head	•	
• Inlet Manifold	•	
• Exhaust Manifold	•	
• Turbine Housing/Coupling As/Impeller Housing	•	
• Front Housing (Body Assembly)	•	
• Injector Group/Pump Group Fuel/Rail Manifold	•	
• Harness Ass-Engine (Electronic Control Module)	•	
• Air Cleaner	•	
• Mount - Rubber / Turbo Catridge	•	

• Available

ဖုန်း- ရန်ကုန်-(၉၅-၉)၉၇၇၀၀၀၇၇၇၊ မန္တလေး-(၉၅-၂)၅၁၅၂၃၄၅၊ ၅၁၅၂၃၄၆ Hotline: (၉၅-၉)၇၇၀၄၇၀၉၄



M S P

